

# The Osaka Marathon 2019 Traffic Regulation Information

## Sunday, December 1, 2019

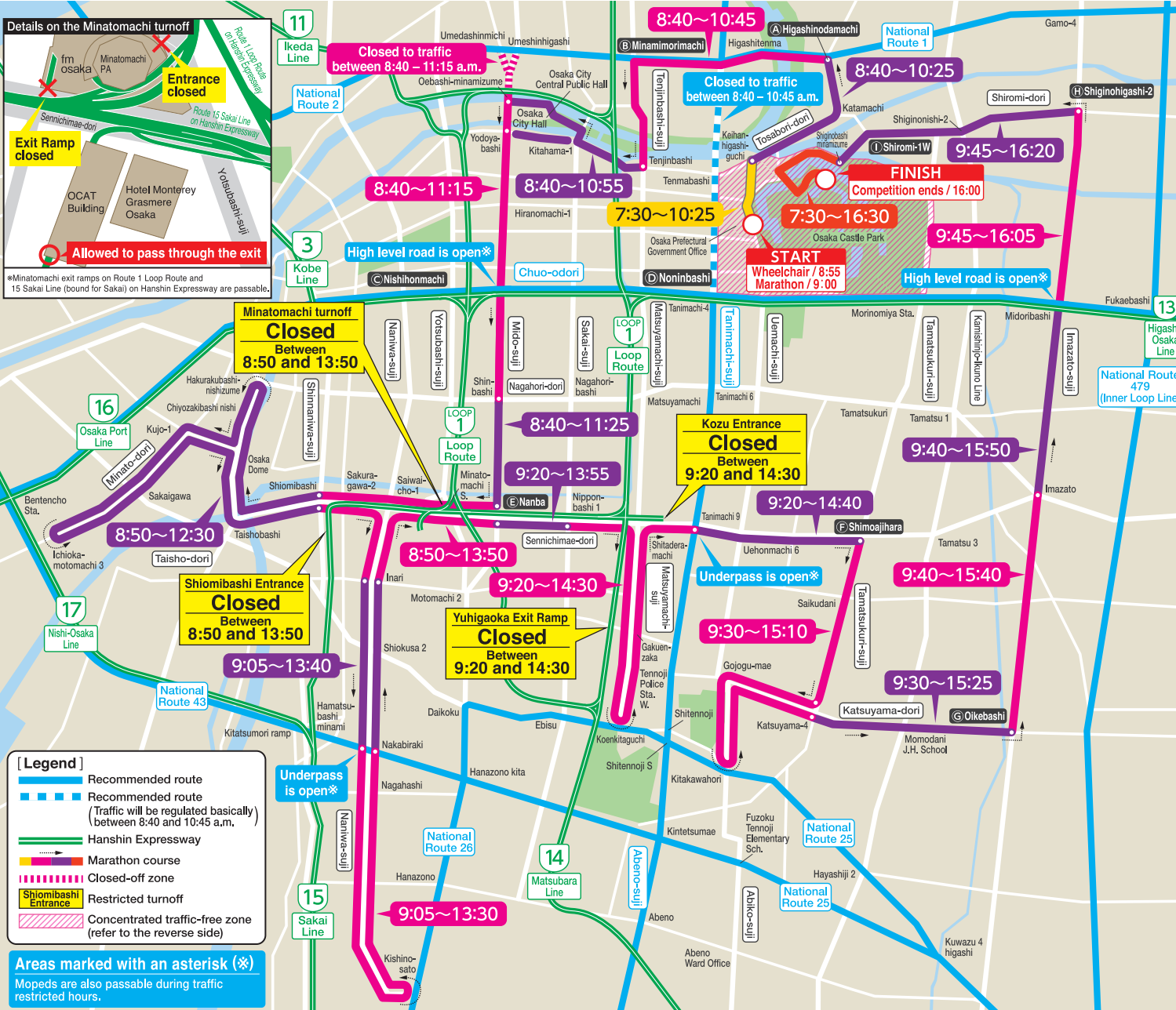

Traffic regulated hours

Basically between  
7:30 a.m. and 4:30 p.m.



Stopping, standing and parking will all be prohibited within the marathon course.



During the traffic restrictions, passing and/or crossing the road is prohibited. Crossing the road on the marathon course for bicycles and pedestrians will also be restricted. We apologize for the inconvenience and thank you for your understanding in advance.

### Detailed Map of Traffic Regulation

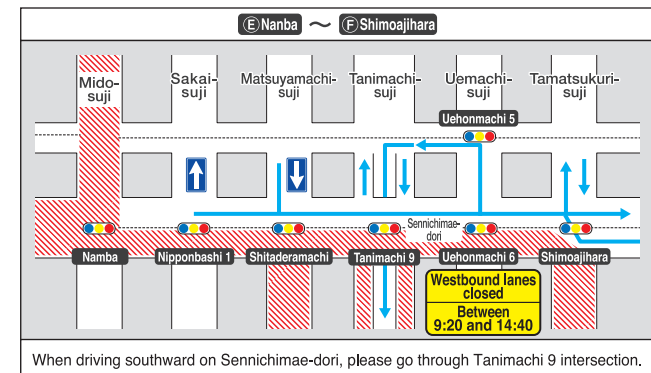
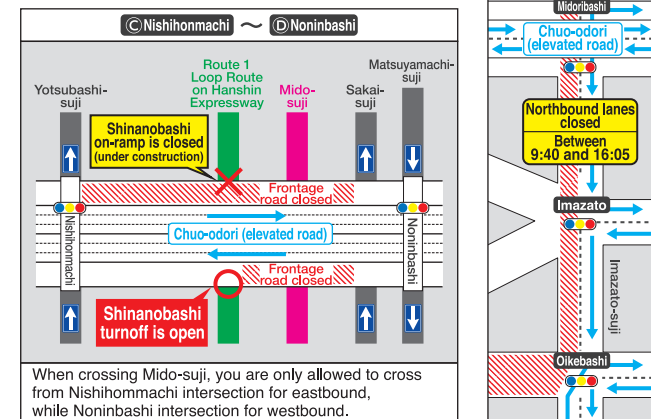
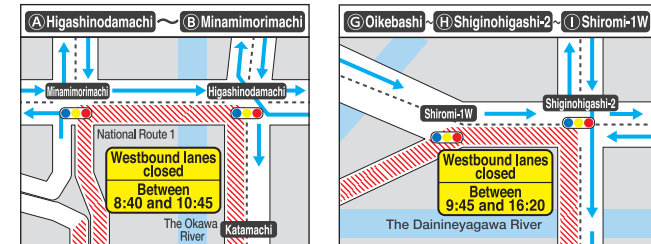

Some turnoffs are closed for vehicle traffic on Hanshin Expressway. When using Hanshin Expressway, please pay attention to information on restricted turnoffs and traffic congestion.

We ask for your cooperation to conduct the event safely. The Osaka Marathon Organizing Committee / Osaka Prefectural Police



# The Osaka Marathon 2019 Traffic Regulation Information

## Sunday, December 1, 2019

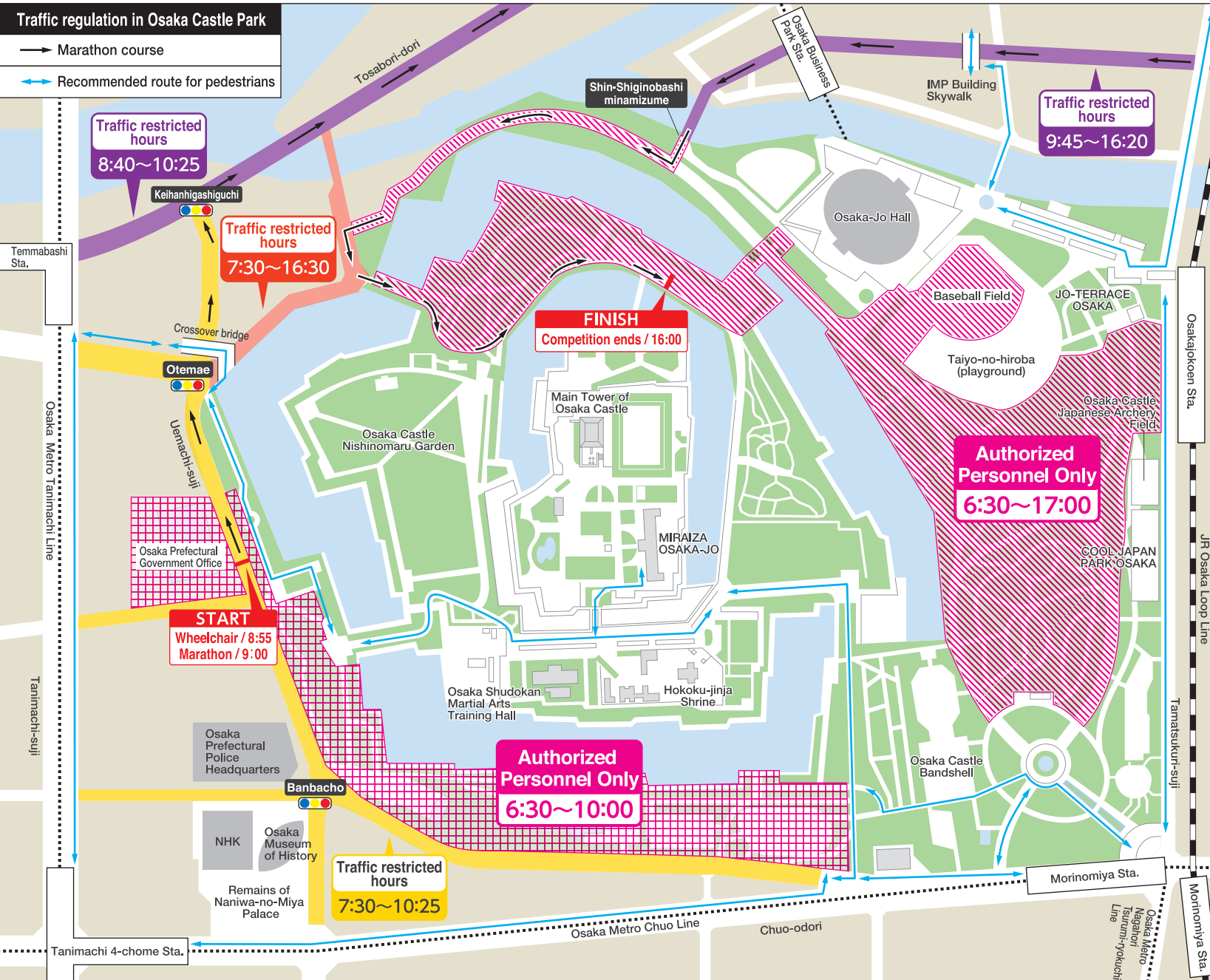

The parking space in Osaka Castle Park is not available throughout the day.

We ask for your cooperation to conduct the event safely.

- Crossing the marathon course is prohibited during the traffic restriction hours.
- Passing through the road on the marathon course for bicycles and pedestrians will also be restricted. We ask pedestrians to use the overpass or pedestrian tunnel, etc.
- The marathon course and its nearby roads will be closed up to over eight hours.
- When driving a car, we advise you to take a recommended route, major open route or expressway.

Searching for a detour route, is available on the Osaka Marathon Official website.



[http://www.osaka-marathon.com/2019/info/traffic/index\\_en.html](http://www.osaka-marathon.com/2019/info/traffic/index_en.html)

### Inquiries

Secretariat of the Osaka Marathon Organizing Committee

[ Traffic regulation help desk ]

[ Tel. ] 06-6614-2811

[ Fax. ] 06-6614-2855

### [ Office hours ]

10:00 a.m. – 7:00 p.m.  
(excluding weekends and national holidays)

○ Fri., Nov. 29 and Sat. Nov. 30, 2019:  
9:00 a.m. – 9:00 p.m.

○ Sun., Dec. 1, 2019: 7:00 a.m. – 5:00 p.m.